



By Roofers for Roofers

# DIPRO P4600 mobile profiling machine

*Special work-site machine: maximum mobility and robustness!*



## Key Advantages

- + On-site mobility
- + Easy to use
- + Compact



**DIMOS  
INNOVATION**

**DIMOS**  
ZI - 648, rue du Tertre  
BP 80029 - 44151 ANCENIS Cedex FRANCE  
Tél. : +33(0) 240 832 501 - Fax: +33(0) 240 832 575  
contact@dimos.fr - www.dimos.fr

# Advantages of the DIPRO-P4600 profiling machine

## MOBILE AND EASY TO TRANSPORTE



- Easy to move **by one person** with extendable handle
- **Highly manoeuvrable** thanks to an optimal weight distribution allowing it to be moved **with only one hand** : 10 kg at arm's length.



- One person can place it into a truck with ramps.

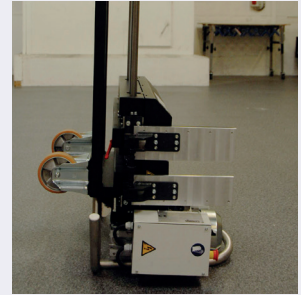
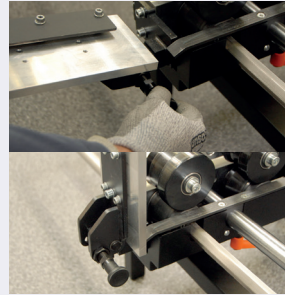

- **Equipped with 2 lifting lugs**, the DIPRO-P4600 can be placed in a sling and is easily transportable on the roof.

- **Foldable input guides**: Reduces the space needed for easy transport.

## COMPACT

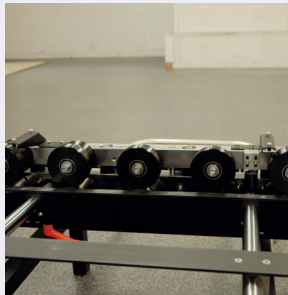

- **5 roll profiling train**: to obtain the best compactness of the profiling train while maintaining an optimal profiling quality. The large 90 mm diameter rollers tried and tested on the other roll-forming machines in the range have been kept and optimised by our engineers to respond to the dynamic behaviour of each material.
- Its **retractable stainless** steel handle and foldable entry guides save space in the workshop, on site or during transport (L 1.30m x W 0.92m).
- The specific shape of the bumper ensures its stability in a vertical position.



## Advantages of the DIPRO-P4600 profiling machine

### EASY TO USE AND PROFILE

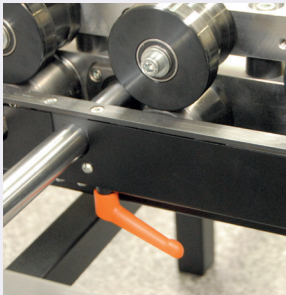

- **Tool-free operation:** the profiling width and the height of the exit roller can be adjusted using the levers.
- **No adjustment** of the roll forming train required.
- **The exit roller** allows the horizontal position of the profile panel to be maintained by means of a precise and tool-free adjustment.
- For profiling **all types of metals**.
- Profiling width **230 to 700 mm**.

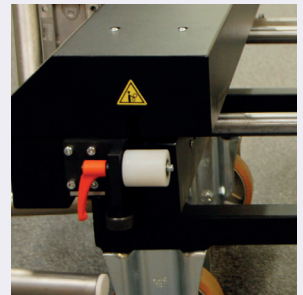

### SUSTAINABILITY AND SAFETY



- Strong stainless steel **bumpers**.
- **Protection housings** for the roll forming train.
- Width adjustment of profiling machine with roller bearing guide rails.
- **Chrome-plated rods** for longer lifespan.
- No part can be lost, all parts are attached security

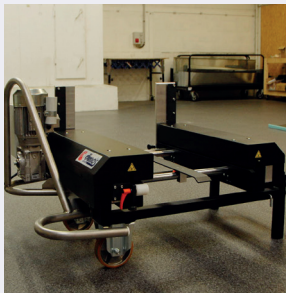
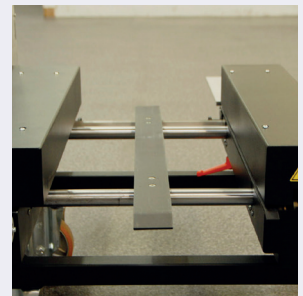

- Complies with EC machine regulations, **standard n°2006/42/EC**

What your DIPRO-P4600 profiling machine can do...



Straight tray

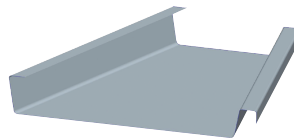

Conical tray

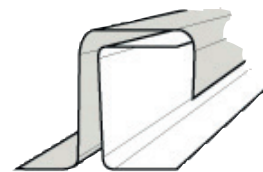

Profile no.1

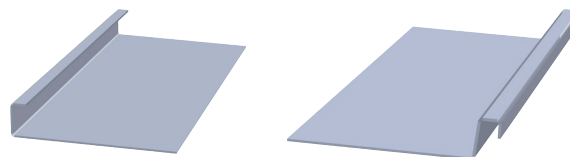

Profiling on one side

## Features & Technical Specifications

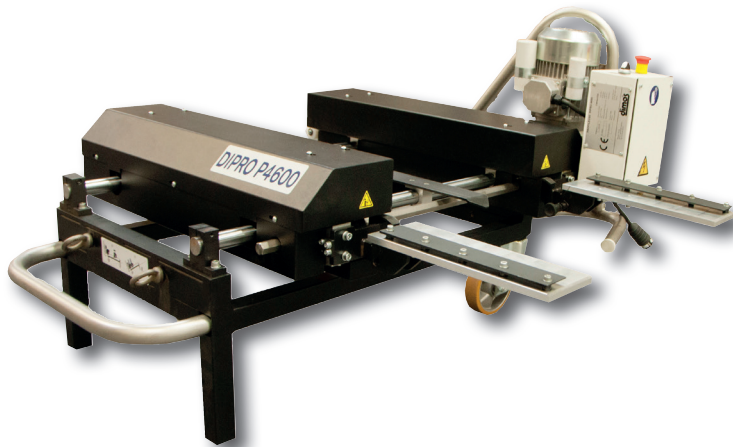

Features	
Length	1,30 m
Width	0,92 m
Height	0,74 m
Weight	160 Kg
Working width	230 à 700 mm
Profiling speed	10 ml / mn
Single-phase motor	110V ou 220 V
Minimum tray length	800 mm

Technical Specifications	
Steel 400 N/mm <sup>2</sup>	up to 0,63 mm
Aluminium A5 1/2 hard ness H24	up to 0,80 mm
Copper 1/4 dur	up to 0,80 mm
Stainless steel 470 N/mm <sup>2</sup>	up to 0,50 mm
Zinc	up to 0,80 mm

Ref.	Description/Content
084745	DIPRO P4600 profiling machine 110V
084746	Profileuse DIPRO-P4600 220V

### Accessories and additional products

Mini site decoiler | 0,80m - max. load 150 kg  
Réf. 082001



Hand trolley decoiler | 0,80m - max. load 250 kg  
Réf. 082050

